

REVISIONS	
ISSUE	CHANGES
0	ER 33877 JCA 04/23/92
1	CN 38264 D TML 03/19/01
C	UPDATED NOTES & ADDED WEIGHT, CAGE CODE, & UPDATED PER DMF304 ER32934 KPL 05/24/11
D	ER33571 COL 06/28/11

125-89-9

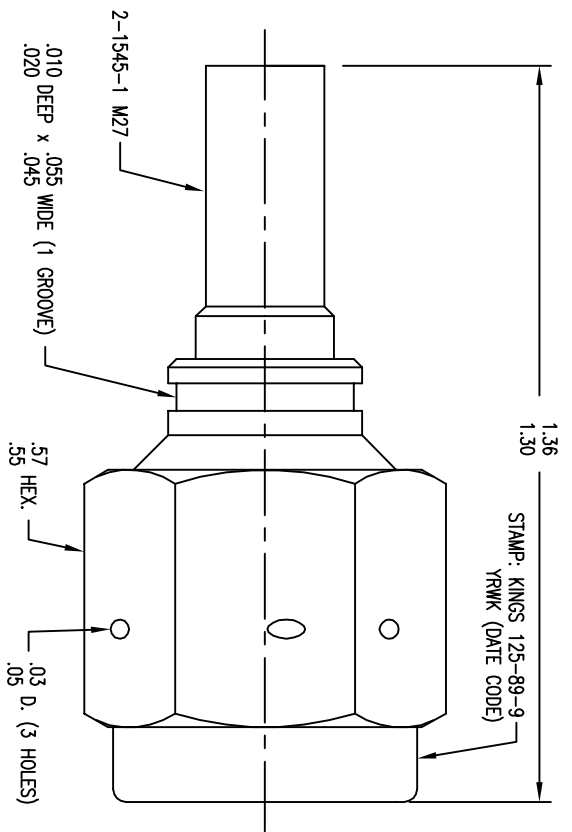

SALES DRAWING

THIS DRAWING, THE DESIGN AND REQS DETERMINED IN THE DRAWING, AND THE MANUFACTURE OF THE PARTS THEREFROM ARE THE PROPERTY OF WINCHESTER ELECTRONICS CORPORATION AND SHALL NOT BE REPRODUCED, COPIED, OR DISCLOSED TO ANYONE IN ANY MANNER WITHOUT THE CONSENT OF WINCHESTER ELECTRONICS CORPORATION.

SCALE 4:1

APPROX SURFACE AREA

WAS: E-17338 & E-19904

REF:

CAGE CODE:91836

PLUG, TNC

DRAWN	JCA	DATE	04/23/92
DESIGN	JT	DATE	04/24/92
APPR.		DATE	

**KINGS**  
Winchester Electronics Corporation  
42 Barnes Industrial Road, North  
Wilmington, Connecticut 06492

125-89-9

- NOTES:
- FOR USE WITH BOEING BMS13-65 OE & ADAMS RUSSELL FC11Z CABLES.
  - FOR CABLING INSTRUCTIONS SEE 3-546-1.
  - FOR CRIMPING USE DIE KTH-2214.
  - INTERFACE PER MIL-STD-348, FIG. 313-1.
  - CENTER CONTACT (1-2359-1MA9) SUPPLIED UNASSEMBLED.
  - MARK PACKAGE: KINGS 125-89-9  
YRWK (DATE CODE)
7. MATERIALS:
- INSULATOR: TEFLON, ASTM-D-1710  
K-GRIP SLEEVE: COM. BRONZE TUBE, ASTM B135  
CONTACT F-M: BER. COPPER, ASTM-B-196  
GASKET: SILICONE RUBBER, A-A-59588  
C-RING: PHOSPHOR BRONZE, ASTM B103  
ALL OTHER METAL PARTS: BRASS, ASTM-B16
8. FINISHES:
- CENTER CONTACT: .000050 MIN GOLD PER ASTM B488 OVER .000050 MIN NICKEL PER AMS-QQ-N-290(ROHS)  
ALL OTHER METAL PARTS: .000050 MIN NICKEL PLATE PER AMS-QQ-N-290 OVER .000050 MIN COPPER PER ASTM B734(ROHS)
9. ELECTRICAL CHARACTERISTICS:
- NOMINAL IMPEDANCE: 50 OHMS  
WORKING VOLTAGE: 500 VRMS  
FREQUENCY RANGE: DC TO 11 GHZ
10. WEIGHT: 16.732 GRAMS